



F13 Direct Drive Motor

Electric Torque Machines (ETM) provides direct drive solutions for demanding applications. ETM manufactures cost effective, high efficiency, high continuous torque, direct drive motors optimized for low speed performance.

Advantages:

- ETM motors provide a **10X continuous torque** advantage over AC induction motors, 3-6X over BLDC motors.
- Enables low cost, compact, lightweight, gearless drive.
- Direct drive eliminates gearbox cost, losses and contamination risk due to oil leaks.
- High efficiency under load at low RPM.

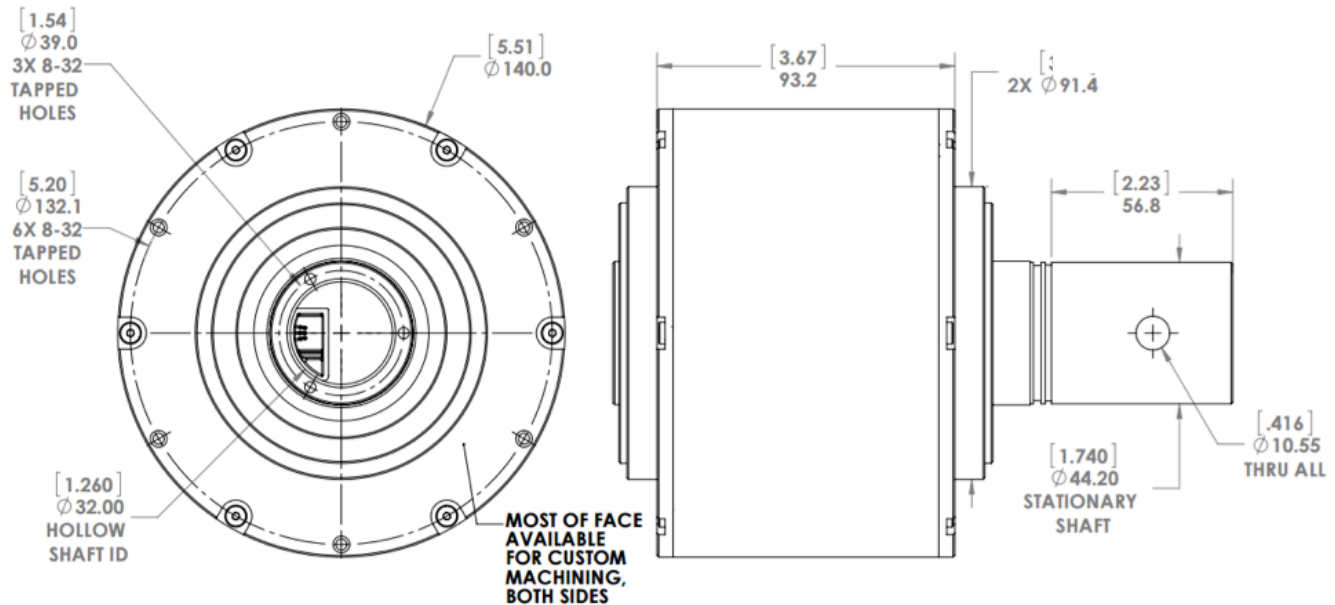



F13 Direct Drive Motor

Specifications		
Continuous Stall Torque (Ambient 45°C, Max Motor Surface Temp = 70°C)	N·m	13.5
	ft·lb	10
Peak Torque (@ 9 Amps Peak)	N·m	40
	ft·lb	29.5
Max Continuous Power @ 300RPM (Ambient 45°C, Max Motor Surface Temp = 70°C)	W	290
	hp	0.38
Max Continuous No Load Speed	rad/s	44
	RPM	420
Weight	kg	6.7
	lb	14.8
Motor Constant (At Continuous Stall Torque)	N·m/vW	2.94
	ft·lb/vW	2.17
Torque Constant (At Continuous Stall Torque)	N·m/A _{pk}	6
	ft·lb/A _{pk}	4.4
BEMF Constant	V _{rms} /kRPM	511
Resistance	Ω _{phs-phs}	5.5
Inductance	mH _{phs-phs}	50
Winding Voltage*	VDC	350
Commutation Sensor	Available with Halls	
Available with Integrated Drive Electronics		

* Other winding voltages available.